

SYLTECH

GEL12-150 12V150AH

GEL SERIES-GEL Battery



Applications

- ◆ Solar system

Specification

Nominal Voltage	12V	
Nominal Capacity(10HR)	150AH	
Dimension	Length	485 ± 3mm (19.09 inches)
	Width	170 ± 2mm (6.69 inches)
	Container Height	240 ± 2mm (9.45 inches)
	Total Height (with Terminal)	240 ± 2mm (9.45 inches)
Approx Weight	Approx 41.2 Kg (90.9lbs)	
Terminal	T11	
Container Material	ABS	
Rated Capacity	160.8 AH/8.04A	(20hr ,1.80V/cell,25°C/77°F)
	150.0 AH/15.0A	(10hr,1.80V/cell,25°C/77°F)
	131.6 AH/26.3A	(5hr,1.75V/cell,25°C/77°F)
	119.3 AH/39.8A	(3hr,1.75V/cell,25°C/77°F)
	96.9 AH/96.9A	(1hr,1.60V/cell,25°C/77°F)
Max. Discharge Current	1500A (5s)	
Internal Resistance	Approx 2.7mΩ	
Operating Temp.Range	Discharge	-30~ 50°C (5 122°F)
	Charge	0~ 40°C (32 104°F)
	Storage	-30~ 40°C (5 104°F)
Nominal Operating Temp. Range	25 ± 3°C (77 ± 5°F)	
Cycle Use	Initial Charging Current less than 45 A.Voltage 14.4V~14.9V at 25°C(77°F)Temp. Coefficient -30mV/°C	
Standby Use	No limit on Initial Charging Current Voltage 13.5V~13.8V at 25°C(77 °F)Temp. Coefficient -20mV/°C	
Capacity affected by Temperature	40°C (104 °F)	103%
	25°C (77 °F)	100%
	0°C (32 °F)	86%
Self Discharge	Techfine GEL series batteries may be stored for up to 9months at 25°C(77°F)and battery should be recharge before use. For higher temperatures the time interval will be shorter.	

Constant Current Discharge (Amperes) at 25 °C (77°F)

F.V/Time	20min	30min	45min	1h	2h	3h	4h	5h	6h	7h	8h	9h	10h	20h
1.85V/cell	114.2	89.6	68.4	57.2	36.3	27.7	22.9	19.8	17.1	15.1	13.6	12.5	11.8	6.48
1.80V/cell	130.8	100.2	75.4	63.2	39.3	29.7	24.3	20.8	17.9	15.8	14.3	13.1	12.3	6.75
1.75V/cell	147.0	110.2	81.5	67.6	41.6	31.3	25.4	21.6	18.6	16.4	14.7	13.5	12.56	6.89
1.70V/cell	158.4	118.0	86.6	71.6	44.1	32.6	26.3	22.3	19.2	16.9	15.2	13.9	12.9	6.97
1.67V/cell	164.8	122.6	89.6	74.3	45.3	33.7	26.9	22.7	19.5	17.2	15.4	14.0	13.0	7.04
1.60V/cell	178.6	131.2	96.3	78.8	47.1	35.0	27.9	23.4	20.0	17.6	15.7	14.3	13.3	7.14

Constant Power Discharge (Watts) at 25 °C (77°F)

F.V/Time	20min	30min	45min	1h	2h	3h	4h	5h	6h	7h	8h	9h	10h	20h
1.85V/cell	218.6	172.7	132.6	111.4	71.0	54.2	45.1	39.1	33.8	30.0	27.1	24.8	23.5	12.9
1.80V/cell	247.1	191.2	145.2	122.4	76.4	57.9	47.6	40.9	35.4	31.3	28.4	26.0	24.5	13.5
1.75V/cell	274.6	208.4	155.8	130.3	80.8	61.0	49.7	42.4	36.5	32.4	29.2	26.8	25.0	13.7
1.70V/cell	292.6	221.2	164.2	137.1	85.2	63.4	51.2	43.6	37.7	33.4	30.0	27.5	25.5	13.9
1.67V/cell	301.2	227.5	168.9	141.4	87.0	65.1	52.3	44.3	38.2	33.8	30.4	27.8	25.8	14.0
1.60V/cell	322.7	241.2	180.1	149.4	90.0	67.4	54.1	45.6	39.0	34.4	30.89	28.32	26.25	14.2

Note The above data are average values, and can be obtained with 3 charge/discharge cycles. These are not minimum values.



GEL12-150 12V150AH

GEL SERIES-GEL Battery

Dimensions

T11 Terminal

Unit: mm [inches]

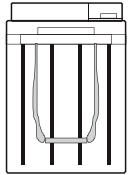
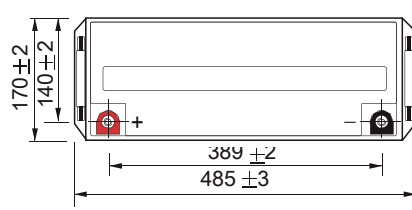
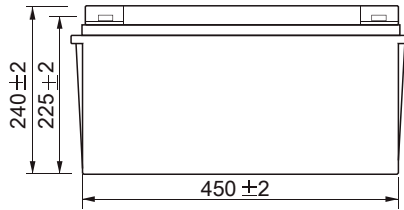
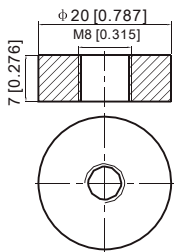

Float Charging Characteristics

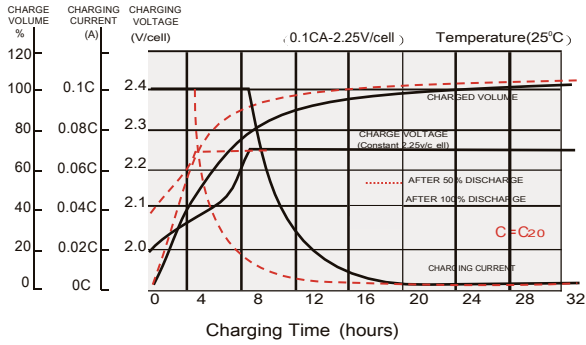

Discharge Characteristics

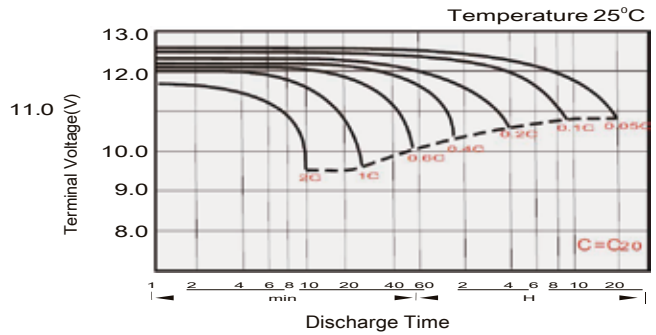

Temperature Effects in Relation to Battery Capacity

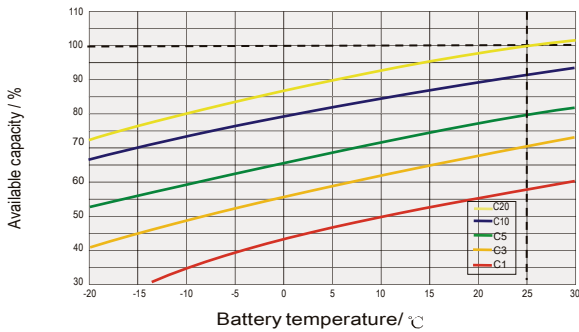

Effect of Temperature on Long Term Float Life

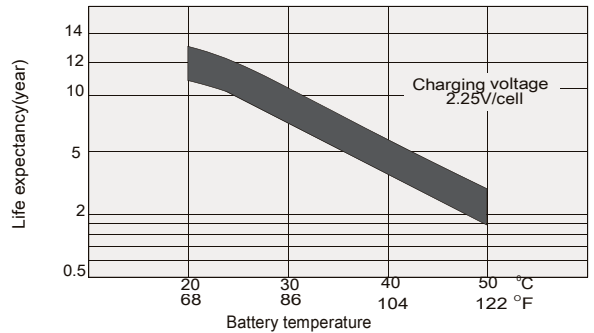

Cycle Life in Relation to Depth of Discharge

Testing condition
 Discharging: current 0.17C (FV 1.7V/cell);
 Charging: current 0.25C max, voltage 2.45V/cell;
 Charging volume: 125% of discharged capacity.

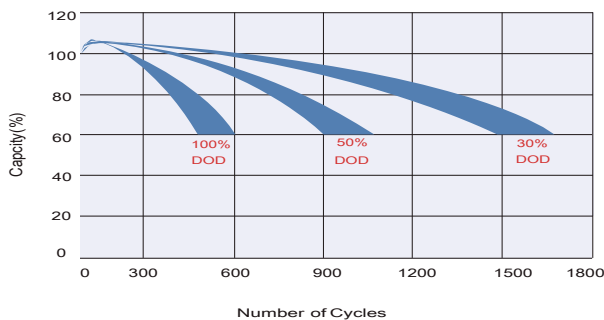

General Relation of Capacity VS. Storage Time

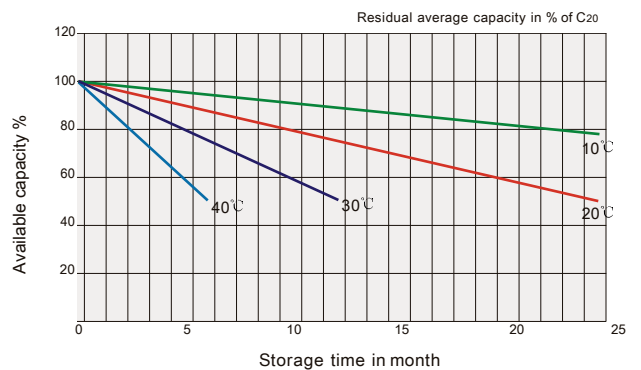

TECHFINE GEL BATTERIES

This information is generally descriptive only and is not intended to make or imply any representation, guarantee or warranty with respect to any cells and batteries. Cell and battery designs/specification are subject to modification without notice. Contact us for the latest information.